



All Ravatherm XPS X products
are Made in Britain

RAVATHERM™ XPS X HANDY GUIDE

RAVAGO HEADQUARTERS | King's Lynn



XPS INSULATION THAT PUTS YOU ON THE MAP

To check the latest version for this document, please visit:
<https://ravagobuildingsolutions.com/uk/en/product-information-versions/>

Handy Guide Version 9 20260209



Contents

About Ravago & Ravatherm XPS X	4
Applications	5
Ravatherm XPS X 300 SB	6
Ravatherm XPS X 300 SL	8
Ravatherm XPS X 500 SL	10
Ravatherm XPS X 700 SL	11
Ravatherm XPS X MK	12
Ravatherm XPS X UB300	13
Ravatherm SW A2 Upstand	14
Technical information	15
Transport & Delivery Options	17
Bulk units, packaging and offloading guidance	19
Contacts	21



About Ravago Building Solutions

Ravago Building Solutions is the UK's original manufacturer of extruded polystyrene (XPS) insulation.

In the UK, our Ravatherm XPS X range of thermal insulation is used in a wide range of roofing, flooring and wall applications.

Our products are made in and despatched from King's Lynn in Norfolk, where we began making the UK's first-ever range of XPS insulation products over 65 years ago. We have been investing in innovation ever since, including being the first XPS manufacturer to introduce

XPS boards with CO₂ and HFO blowing agents, and pioneering the use of infra-red blockers.

Our products come in a range of thicknesses and compressive strengths.

Ravatherm XPS X thermal insulation is manufactured by an extrusion process which results in a homogeneous, closed-cell material structure and smooth surface skin (extrusion skin).

Ravago Building Solutions can provide advice and information in order to help you achieve the solutions you are looking for.

Applications



Inverted flat roofs



Cold store facilities and data centres



Blue roofs



Swimming pools



Green and brown roofs



Below DPC applications



Roof terraces



Car park decks



Residential floors



Passivhaus projects



Basement floors & retaining walls



EWI solutions



Commercial heavy duty floors

RAVATHERM™ XPS X 300 SB



Ravatherm XPS X 300 SB is an XPS thermal insulation board with a butt-edge. It has a declared thermal conductivity of 0.030 W/m.K for thicknesses up to and including 120mm, and 0.031 W/m.K for thicknesses above this.

Due to its low water absorption properties (<0.7% according to BS EN 12087:2013), this product may be used below dpc level in cavity wall applications.

Available in thicknesses from 30mm up to 200mm.

Applications

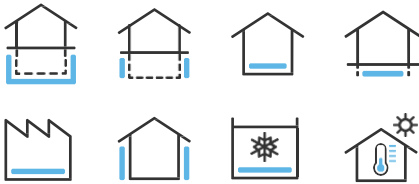

300kPa compressive strength
(according to BS EN 826:2013)

130kPa compressive creep
(2% deformation after 50 years according to BS EN 1606:2013)

Pack & Bulk unit sizes



Thickness (mm)	Width (mm)	Length (mm)	Boards/pack	m ² /pack	Packs/bulk unit	m ² /bulk unit
30	600	2500	14	21	24	504
40	600	2500	10	15	24	360
50	600	2500	8	12	24	288
60	600	2500	7	10.5	24	252
75	600	2500	5	7.5	28	210
80	600	2500	5	7.5	24	210
100	600	2500	4	6	24	144
125	600	2500	3	4.5	28	126
150	600	2500	3	4.5	24	108
200	600	2500	2	3	24	72

Installations

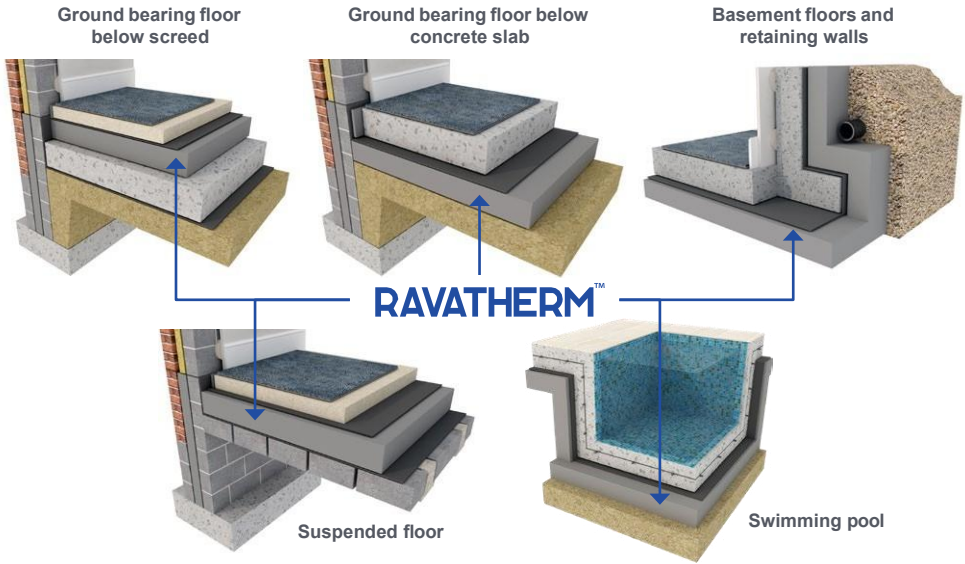

Thermal resistance¹

Thickness(mm)	30	40	50	60	75	80	100	125	150	200
R _d m ² .K/W	1.00	1.30	1.65	2.00	2.50	2.65	3.30	4.00	4.80	6.45

DESIGNATION CODE: XPS-EN 13164-T1-CS(10/Y)300-CC(2/1.5/50)130-DS(70,90)-WL(T)0.7- WD(V)1,2,3(1)-FTCD1

Properties	Value	Unit	Standard
Thermal Conductivity Declared	≤ 120mm > 120mm	0.030 0.031	W/m.K BS EN 13164: 2012+A1:2015
Compressive stress or compressive strength@ 10% deformation	300	kPa	BS EN 826:2013
Compressive Creep max after 50 years < 2% deformation under stress σ _C	130	kPa	BS EN 1606:2013
Water vapour diffusion resistance factor μ (tabulated value)	100	-	BS EN 12086:2013
Long term water absorption by total immersion	< 0.7	%	BS EN 12087:2013
Water pick-up by diffusion	50 < 80mm ≥ 80mm	< 2 < 1	% BS EN 12088:2013
Water pick up after Freeze Thaw	< 1	%	BS EN 12091:2013
Dimensional stability under specified temperature (70°C) and humidity conditions (90%rh)	< 5	%	BS EN 1604:2013
Deformation under specified compressive load (40kPa) and temperature (70°C) conditions	< 5	%	BS EN 1605:2013
Coefficient of linear thermal expansion (typical value)	0.07	mm/(m.K)	-
Reaction to fire classification	E	Euroclass	BS EN 13501-1 :2018
Temperature limits	-50/+75	°C	-
Thickness tolerances	1	Class	BS EN 823:2013
Edge Profile	Butt Edge		
Surface finish	Skin		

RAVATHERM™ XPS X 300 SL



Ravatherm XPS X 300 SL is an XPS thermal insulation board for use on inverted flat roofs, green, brown and blue roofs*. It has a declared thermal conductivity of 0.030 W/m.K for thicknesses up to and including 120mm, and 0.031 W/m.K for thicknesses above this.

Available in thicknesses from 50mm up to 200mm.

Applications



300kPa compressive strength (according to BS EN 826:2013)

130kPa compressive creep (2% deformation after 50 years according to BS EN 1606:2013)

**Green, blue and brown roof applications are outside the scope of the BBA certificate*



Pack & Bulk unit sizes

Thickness (mm)	Width (mm)	Length (mm)	Boards/pack	m ² /pack	Packs/bulk unit	m ² /bulk unit
50	600	1250	8	6	48	288
80	600	1250	5	3.75	48	180
100	600	1250	4	3	48	144
115	600	1250	3	2.25	56	126
120	600	1250	3	2.25	56	126
130	600	1250	3	2.25	56	126
140	600	1250	3	2.25	48	108
145	600	1250	3	2.25	48	108
160	600	1250	2	1.5	64	96
165	600	1250	2	1.5	64	96
175	600	1250	2	1.5	56	84
180	600	1250	2	1.5	56	84
190	600	1250	2	1.5	48	72
195	600	1250	2	1.5	48	72
200	600	1250	2	1.5	48	72

Installations

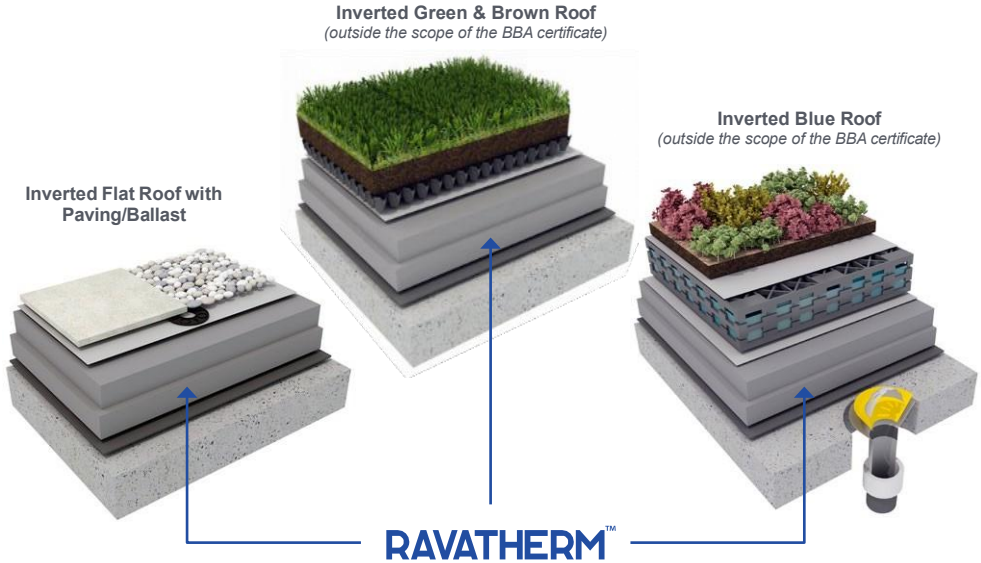

Thermal resistance¹

Thickness(mm)	50	80	100	115	120	130	140	145	160	165	175	180	190	195	200
R _d m ² .K/W	1.65	2.65	3.3	3.8	4.0	4.15	4.5	4.65	5.15	5.3	5.6	5.8	6.1	6.25	6.45

DESIGNATION CODE: XPS-EN 13164-T1-CS(10\Y)300-CC(2/1.5/50)130-DS(70,90)-WL(T)0.7- WD(V)1,2,3^(U)-FTCD1

Properties	Value	Unit	Standard
Thermal Conductivity Declared	≤ 120mm	0.030	W/m.K
	> 120mm	0.031	W/m.K
Compressive stress or compressive strength@ 10% deformation	300	kPa	BS EN 826:2013
Compressive Creep max after 50 years < 2% deformation under stress σC	130	kPa	BS EN 1606:2013
Water vapour diffusion resistance factor μ (tabulated value)	100	-	BS EN 12086:2013
Long term water absorption by total immersion	< 0.7	%	BS EN 12087:2013
Water pick-up by diffusion	50 < 80mm	< 2	BS EN 12088:2013
	≥ 80mm	< 1	
Water pick up after Freeze Thaw	< 1	%	BS EN 12091:2013
Dimensional stability under specified temperature (70°C) and humidity conditions (90%rh)	< 5	%	BS EN 1604:2013
Deformation under specified compressive load (40kPa) and temperature (70°C) conditions	< 5	%	BS EN 1605:2013
Coefficient of linear thermal expansion (typical value)	0.07	mm/(m.K)	-
Reaction to fire classification	E	Euroclass	BS EN 13501-1:2018
Temperature limits	-50/+75	°C	-
Thickness tolerances	1	Class	BS EN 823:2013
Edge Profile	Ship lap		
Surface finish	Skin		

RAVATHERM™ XPS X 500 SL

Ravatherm XPS X 500 SL is used on heavy-duty inverted roofs, floor structures and load-bearing base slabs. The board has low water absorption (<0.7% according to BS EN 12087:2013).

Available in 50mm, 75mm, and 100mm thicknesses.

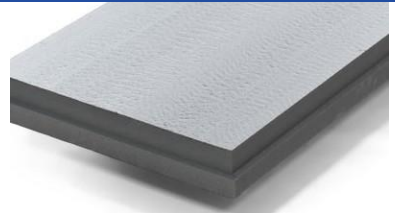

Applications



500kPa compressive strength
(according to BS EN 826:2013)

180kPa compressive creep (2% deformation after 50 years according to BS EN 1606:2013)

Thermal resistance ¹				
Thickness(mm)	50	75	100	
R _d m ² .K/W	1.60	2.40	3.20	
DESIGNATION CODE: XPS-EN 13164-T1-CS(10\Y)500-CC(2/1.5/50)180-DS(70,90)-WL(T)0.7- WD(V)1,2,3 ⁽¹⁾ -FTCD1				
Properties	Value	Unit	Standard	
Thermal Conductivity Declared	0.031	W/m.K	BS EN 13164: 2012+A1:2015	
Compressive stress or compressive strength@ 10% deformation	500	kPa	BS EN 826:2013	
Compressive Creep max after 50 years < 2% deformation under stress σC	180	kPa	BS EN 1606:2013	
Water vapour diffusion resistance factor μ (tabulated value)	100	-	BS EN 12086:2013	
Long term water absorption by total immersion	< 0.7	%	BS EN 12087:2013	
Water pick-up by diffusion	50 < 80mm ≥ 80mm	< 2 < 1	BS EN 12088:2013	
Water pick up after Freeze Thaw	< 1	%	BS EN 12091:2013	
Dimensional stability under specified temperature (70°C) and humidity conditions (90%rh)	< 5	%	BS EN 1604:2013	
Deformation under specified compressive load (40kPa) and temperature (70°C) conditions	< 5	%	BS EN 1605:2013	
Coefficient of linear thermal expansion (typical value)	0.07	mm/(m.K)	-	
Reaction to fire classification	E	Euroclass	BS EN 13501-1:2018	
Temperature limits	-50/+75	°C	-	
Thickness tolerances	1	Class	BS EN 823:2013	
Edge Profile	Ship lap			
Surface finish	Skin			

Pack & Bulk unit sizes

Thickness (mm)	Width (mm)	Length (mm)	Boards/pack	m ² /pack	Packs/bulk unit	m ² /bulk unit
50	600	1250	8	6	48	288
75	600	1250	5	3.75	56	210
100	600	1250	4	3	48	144
120**	600	1250	3	2.25	56	126
140**	600	1250	3	2.25	48	108

**Made to order / may be subject to minimum run

RAVATHERM™ XPS X 700 SL

Ravatherm XPS X 700 SL is used in load-bearing industrial floors, base slabs and high-load rooftop car parks. It has a declared thermal conductivity of 0.031 W/m.K and low water absorption (<0.7% according to BS EN 12087:2013).

Available in 50mm, 75mm, and 100mm thicknesses.

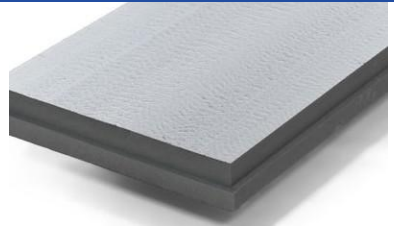

Applications



700kPa compressive strength
(according to BS EN 826:2013)

250kPa compressive creep (2% deformation after 50 years according to BS EN 1606:2013)

Thermal resistance ¹			
Thickness(mm)	50	75	100
R _d m ² .K/W	1.60	2.40	3.20
DESIGNATION CODE: XPS-EN 13164-T1-CS(10Y)700-CC(2/1.5/50)250-DS(70,90)-WL(T)0.7-WD(V)1,2,3⁴-FTCD1			
Properties	Value	Unit	Standard
Thermal Conductivity Declared	0.031	W/m.K	BS EN 13164:2012+A1:2015
Compressive stress or compressive strength@ 10% deformation	700	kPa	BS EN 826:2013
Compressive Creep max after 50 years < 2% deformation under stress σC	250	kPa	BS EN 1606:2013
Water vapour diffusion resistance factor μ (tabulated value)	100	-	BS EN 12086:2013
Long term water absorption by total immersion	< 0.7	%	BS EN 12087:2013
Water pick-up by diffusion	50 < 80mm ≥ 80mm	< 2 < 1	% BS EN 12088:2013
Water pick up after Freeze Thaw	< 1	%	BS EN 12091:2013
Dimensional stability under specified temperature (70°C) and humidity conditions (90%rh)	< 5	%	BS EN 1604:2013
Deformation under specified compressive load (40kPa) and temperature (70°C) conditions	< 5	%	BS EN 1605:2013
Coefficient of linear thermal expansion (typical value)	0.07	mm/(m.K)	-
Reaction to fire classification	E	Euroclass	BS EN 13501-1:2018
Temperature limits	-50/+75	°C	-
Thickness tolerances	1	Class	BS EN 823:2013
Edge Profile	Ship lap		
Surface finish	Skin		

Pack & Bulk unit sizes

Thickness (mm)	Width (mm)	Length (mm)	Boards/pack	m ² /pack	Packs/bulk unit	m ² /bulk unit
50	600	1250	8	6	48	288
75	600	1250	5	3.75	56	210
100	600	1250	4	3	48	144
120**	600	1250	3	2.25	56	126

**Made to order / may be subject to minimum run

RAVATHERM™ XPS X MK

XPS X MK
 wasserableitende, diffusionsoffene Trennlage
 techno-textile limitant le passage d'eau
 water-flow reducing layer
 RAVATHERM™ is trademark of Ravago Building Solutions SA
 Overlap (Requis)

Ravatherm XPS X MK is a water flow reducing layer (WFRL) used in conjunction with Ravatherm XPS X 300 SL. A WFRL is a critical component of an inverted flat roof, minimising heat loss due to the rainwater cooling effect. This product is a polyethylene geotextile.

Applications



Width of roll	Length of roll	Weight for m ²	Weight of roll
1,5 m	50 m	~ 63 g/m ²	~ 5 kg
3,0 m	100 m	~ 63 g/m ²	~ 19 kg

Properties	Method	Unit	Values
Reaction to fire classification	BS EN ISO 11925-2:2020	class	E*
Water tightness	BS EN 1928:2000 (A)	class	W1
Sd-value	BS EN ISO 12572:2016	m	0,01 (+0,015/-0,007)
Tensile force (MD)	BS EN 12311-1:2000	N/5cm	310 ± 50
Elongation (MD)	BS EN 12311-1:2000	%	17 ± 5
Tensile force (XD)	BS EN 12311-1:2000	N/5cm	310 ± 50
Elongation (XD)	BS EN 12311-1:2000	%	20 (± 6)
Nail Shank (MD)	BS EN 12310-1:2025	N	55 ± 20
Nail Shank (XD)	BS EN 12310-1:2025	N	50 ± 20
Flexibility at low temperature	BS EN 1109:2013	°C	-40
Artificial aging by UV and heat:			
Tensile force (MD)	BS EN 12311-1:2000	%	-15
Elongation (MD)	BS EN 12311-1:2000	%	-25
Tensile force (XD)	BS EN 12311-1:2000	%	-15
Elongation (XD)	BS EN 12311-1:2000	%	-30
Water tightness	BS EN 1928:2000 (A)	class	W1

RAVATHERM™ XPS X UB300

Ravatherm XPS X UB300 pairs the thermal performance of Ravatherm XPS X 300 SB with a 6mm fibre cement layer, resulting in an insulation board which is used on parapets and upstands to reduce thermal bridging at junctions. The product helps to avoid thermal bridging in flat roofs.

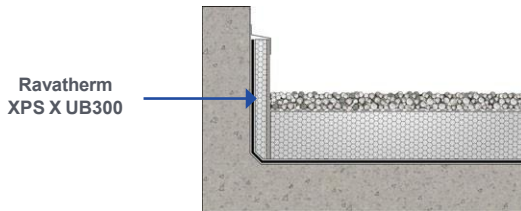

Properties	Value	Unit	Standard
Thermal Conductivity Declared	0.030	W/m.K	BS EN 13164: 2012+A1:2015
Compressive stress or compressive strength@ 10% deformation	300	kPa	BS EN 826:2013
Tensile strength	300	kPa	BS EN 1607:2013
Water vapour diffusion resistance factor μ (tabulated value)	-	-	BS EN 12086:2013
Long term water absorption by total immersion	1.5	%	BS EN 12087:2013
Dimensional stability under specified temperature (70°C) and humidity conditions (90%rh)	< 5	%	BS EN 1604:2013
Coefficient of linear thermal expansion (typical value)	0.07	mm/(m.K)	-
Reaction to fire classification	E	Euroclass	BS EN 13501-1:2018
Temperature limits	-50/+75	°C	-
Tolerances	Thickness	-0.5/+0.5	mm
	Width	-3/+3	mm
	Length	-6/+6	mm

Edge profile

Butt edge

DESIGNATION CODE: XPS - EN 13164 - T3 -CS(10Y)300 - DS(70,90) - WL(T)1,5 - TR200

Surface finish

6 mm fibre cement flat sheet

Tolerances	Thickness	-0/+0.6	mm
	Width	+0/-2	mm
	Length	+0/-2	mm

1 N/mm² = 10³ kPa = 1MPa

Pack size

Thickness (mm)	Width (mm)	Length (mm)	Boards/pallet	m ² /pallet	Pallets/bulk unit	m ² /bulk unit
56	600	1200	42	30.24	8	241.92

Dimension shows overall product thickness including 6mm fibre cement flat sheet. Insulation is 50mm XPS

RAVATHERM™ SW A2 Upstand

Ravatherm SW A2 Upstand pairs Ravago stonewool insulation slab with a 6mm fibre cement layer and is used vertically as an upstand board in the Inverted Roof finish. It meets the current Approved Document B of the Building Regulations requirement that any attachment to the external walls of relevant buildings above 11m in height must use non-combustible materials in order to be compliant. Our new Ravatherm SW A2 Upstand board has been tested for Reaction to Fire Classification (according to BS EN 13501-1:2018) and achieves a Euroclass A2-s1, d0 classification.



Properties	Value	Unit	Standard
Non-Combustible Upstand Insulation Board			
Reaction to fire classification	A2-s1, d0	-	BS EN 13501-1:2018
Board size	Thickness (inc. facing)	56	mm
	Width	600	mm
	Length	1200	mm
Board weight	13.8	kg/m ²	
Facing fibre cement board			
Colour	Grey		
Thickness	6	mm	BS EN 823:2013
Density	1375	kg/m ³	BS EN 1602:2013
Reaction to fire classification	A1	-	BS EN 13501-1:2018
Insulation Mineral wool			
Thickness	50	mm	BS EN 823:2013
Compressive strength @10% deformation	≥ 20	kPa	BS EN 826:2013
Thermal conductivity declared	0.035	W/m.K	BS EN 12667:2001
Thermal resistance	1.43	m ² /KW	BS EN 13162: 2012+A1:2015
Density	110	kg/m ³	BS EN 1602:2013
Short term water absorption	<1	kg/m ²	BS EN 1609:2013
Reaction to fire classification	A1	-	BS EN 13501-1:2018

1 N/mm² = 10³ kPa = 1MPa

Pack size

Thickness (mm)	Width (mm)	Length (mm)	Boards/pallet	m ² /pallet	Pallets/bulk unit	m ² /bulk unit
56	600	1200	42	30.24	8	241.92
Dimension shows overall product thickness including 6mm fibre cement flat sheet. Insulation is 50mm stonewool						

Technical information

U-Value Calculations

The Ravago Building Solutions UK technical team can run U-Value calculations for your projects. In order to calculate, we need the following information:

Floors

- Floor build up from soil to floor finish and floor type i.e. Ground bearing or Suspended
- The total floor area (m²)
- The exposed perimeter (linear metres)
- Target U-Value required
- For basement floor and walls, we also need to know the average floor to ceiling height

Inverted roofs

- Roof build up from internal to external
- Project location i.e. London, Manchester, Glasgow etc.
- Target U-Value required

Solid ground bearing floor										
U-values	P/A	0.1	0.2	0.3	0.4	0.5	0.6	0.7	0.8	0.9
0.10		160	220*	240*	240*	260*	260*	260*	260*	260*
0.11		135	175	220*	220*	220*	240*	240*	240*	240*
0.12		120	175	200	200	200	220*	220*	220*	220*
0.15		60	125	140	150	160	160	160	170	170
0.18		40	90	110	120	125	125	125	140	140
0.20		40	75	90	100	105	130	115	125	125
0.22		40	60	75	90	100	100	100	120	120
0.25		40	50	70	70	80	90	90	90	90
no insulation		0.26W/ m ² K	0.43W/ m ² K	0.56W/ m ² K	0.67W/ m ² K	0.76W/ m ² K	0.84W/ m ² K	0.91W/ m ² K	0.97W/ m ² K	1.02W/ m ² K

Required Ravatherm XPS X 300 SB thickness (mm) to meet U-values W/m.K - Floor finish 65mm incorporating a 30mm vertical perimeter insulation

*Thickness achieved using a double layer of insulation

U-values in accordance with BR 443 'Conventions for the calculation of U-values' (2019 edition), using calculation methods in BS EN ISO 6946:2017 and BS EN ISO 13370:2017.

A default soil thermal conductivity of 2.0 W/m.K should be used, unless otherwise verified and the floor slab should not be included unless adequately defined.

Inverted Roof					
U-value	0.17	0.15	0.14	0.12	0.10
Ravatherm XPS X 300 SL	175	200	220*	250*	300*

Table 1: Required Ravatherm XPS X 300 SL thickness (mm) to meet U-values W/m.K using the Ravatherm XPS X MK system

Roof build-up: Ballast (aggregate/pavers) Ravatherm XPS X MK
Ravatherm XPS X 300 SL Geotextile separation layer (if required)
Hot melt waterproofing Reinforced concrete deck 200mm

Rainwater cooling penalty calculated to BS EN ISO 6946:2017 Annex D4,
p=3mm/day *2 layers of insulation required

Thermal performance

Ravatherm XPS X's declared thermal conductivity ranges between 0.030 and 0.031 W/m.K. In an inverted roof construction, the product can be used with Ravatherm XPS X MK water flow reducing layer above the insulation to minimise the 'rainwater cooling effect'.

To meet Building Regulations, this effect must be taken into account by using design conductivity (λ_u) rather than declared conductivity (λ_D), and a moisture correction factor as per BS EN ISO 10456:2007 (or ETAG 031) to provide the U-value correction (ΔU_r) for calculated roof U values in accordance with Section 7 and Annex F.4 of BS EN ISO 6946:2017.

Fire

Inverted roofs ballasted with incombustible material, such as aggregate or paving slabs, achieve the external fire rating of B_{roof}(t4) which make the roof unrestricted with respect to proximity to a relevant boundary under Approved Document B of the Building Regulations.

Transport & Delivery Options

At Ravago Building Solutions UK, we understand that construction sites do not always need full loads of products on site – that’s why we offer delivery of less than a full load. Please see below our two delivery options.

Standard delivery option

- Deliveries are completed on curtain sided articulated vehicles, flat-bed articulated vehicles are available upon request.
- Flat-bed rigid vehicles available upon request and subject to extra charges.
- FORS Gold available upon request, subject to availability.

Flexible delivery option

- Deliveries are completed on curtain sided articulated vehicles or other vehicle type that may be available.
- Date or time cannot be specified, deliveries will be completed within 7-10 working days.
- RBS UK Customer Service Team will confirm exact delivery date at least 48 hours prior to delivery.
- If specific delivery date/time is required refer to standard delivery option and charges.

	England & Wales (Mainland only)		Scotland (Mainland only)	
	Standard delivery	Flexible delivery	Standard delivery	Flexible delivery
Lead Time	3-4 working days	within 7 working days	4-5 working days	within 10 working days
Full load (5 bulk units)	Free of charge	Free of charge	Free of charge	Free of charge
3-4 bulk units	Refer to postcode charter	Free of charge	Refer to postcode charter	Free of charge
Less than 3 bulk units*	Refer to postcode charter	£150	Refer to postcode charter	£275

*Minimum sized order we accept for delivery is at least 1 bulk unit.

	Curtain Sided Artic	Flatbed Artic	Rigid Flatbed
Full bulk unit quantity only	No	Yes	Yes
Maximum bulk units per load	5	5	3
Delivery charge for full truck load	No	No	Yes
Timed deliveries possible - Standard	Yes	Yes	PM Only
Timed deliveries possible - Flexible	No	No	No

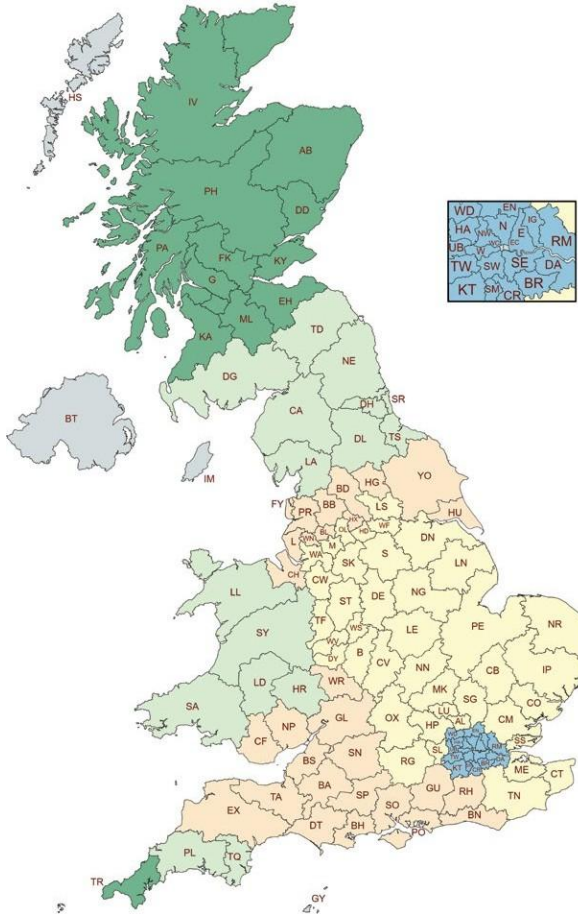

Delivery Surcharge Postcode Zones

- Zone 1
- Zone 2
- Zone 3
- Zone 4 London
- Zone 5

Postcode Charter						
Zone	Standard delivery - No of Bulk Units per Load					Flexible Less than 3 bulk units
	5/Full load	4	3	2	1	
1	No cost	£80.00	£160.00	£240.00	£300.00	£150.00
2	No cost	£110.00	£220.00	£320.00	£360.00	£150.00
3	No cost	£130.00	£260.00	£360.00	£400.00	£150.00
4	No cost	£95.00	£190.00	£290.00	£330.00	£150.00
5	No cost	£220.00	£440.00	£660.00	£880.00	£275.00

Charges based to deliveries to Mainland UK only

Bulk units / inner units offloading

Ravatherm XPS X products are packaged in bulk units as standard.

The bulk unit dimensions are (W) 2.4m x (L) 2.5m x (H) 2.6m to 2.95m
(height varies depending on thickness of product ordered).

Ravatherm XPS X 300SL, 500SL and 700SL can be broken down to 8 pre-wrapped inner units measuring (W) 1.2m x (L) 1.25m x (H) 1.3m to 1.66m

Ravatherm XPS X 300SB can be broken into 4 pre-wrapped inner units measuring (W) 1.2m x (L) 2.5m x (H) 1.3m to 1.6m. As standard loading procedure we will remove the outer wrap on Ravatherm XPS X 300SB product allowing for the pre-wrapped inner units to be offloaded individually.

Orders for quantities other than full bulk units may be loaded as loose packs.

Bulk unit

2.4m x 2.5m x 2.95m



Bulk unit half-height



8 pre-wrapped inner units



Single inner unit

1.2m x 1.25m x 1.66m



Single pack

0.6m x 1.25m x 0.4m



Crane, Long forks or fork extensions required to offload



Standard forklift can offload

Dimensions: W=Width, L=Length, H=Height

Please Note: Height is Maximum and will vary depending on product thickness.



How to offload and unpack bulk units into four or eight convenient units

- Unload bulk unit from truck bed with a forklift and fork extensions
- Slit outer wrap horizontally along the mid-height bearers
- Lift away top half and set down so you have two half-height bulk units
- Slit outer wrap vertically
- Separate into eight prewrapped inner units



Collections available from Ravago Building Solutions plant

Collection address:

Ravago Building Solutions UK, Estuary Road, King's Lynn, Norfolk PE30 2HJ

Conditions for collections will be sent with your order confirmation, and a collection reference will be provided which must be presented upon arrival.

Contacts

Orders & General Enquiries

orders.uk.rbs@ravago.com

Customer Service Contacts

Amanda Steward	03300 606015	orders.uk.rbs@ravago.com
Danielle Birchenough	03301 096129	orders.uk.rbs@ravago.com
Bobbie-Jaye Yates	03300 606007	orders.uk.rbs@ravago.com
Oliver Foster	03301 096141	orders.uk.rbs@ravago.com
Louie Claydon	03301 096133	orders.uk.rbs@ravago.com

Account Manager Distribution

Adam Hilmi (North England & Scotland)	07436 145034	adam.hilmi@ravago.com
Natalie Sutton (South England & Midlands)	07976 530510	natalie.sutton@ravago.com

Roofing Products Sales Manager UK & Ireland

Richard Powell	07967 496011	richard.powell@ravago.com
----------------	--------------	--

Technical Contact

Help Desk	03301 096136	technical.uk.rbs@ravago.com
-----------	--------------	--





RAVAGO BUILDING SOLUTIONS

Estuary Road
King's Lynn
PE30 2HJ

www.ravagobuildingsolutions.co.uk

General Enquiries
+44 3301 096138



All Ravatherm XPS X products
are Made in Britain

Partner of



Certifications



The prices, technical details and other information included in this literature are correct at the time of publication. For an up-to-date library of product information, users should visit the website www.ravagobuildingsolutions.co.uk or contact our team. Product suitability should only be determined following a detailed U-value calculation for each individual project, please contact Ravago Building Solutions UK Technical help desk for assistance technical.rbs.uk@ravago.com. The information herein is meant only as guidance for the user. Recommendations for use should be verified as to the suitability and compliance with actual requirements, specifications and any applicable laws and regulations. For other applications or conditions of use, contact Ravago Building Solutions UK Technical help desk for assistance. Ravago Building Solutions UK reserves the right to amend product specifications without prior notice.